

KCAX

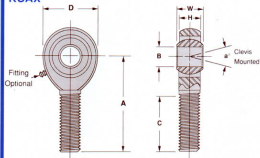

PART NO.		DIMENSIONS IN INCHES										Radial Static Load Cap. Lbs.	Approx. Brg. Wt. Lbs.
Right Hand	Left Hand	B	W	H	A	D	Ball Dia. Ref.	C	Thread UNF-3A	α ° Mounting Angle			
KCAX5	KCAXL5	.3125 + .0015 - .0005	.437 + .000 - .005	.344 ± .005	1.938 ± .015	1.000 ± .010	.625	1.250 + .062 - .031	3/8-24	12	5.589	.06	
KCAX6	KCAXL6	.3750	.500	.406	2.125	1.125	.719	1.375	7/16-20	10	7.539	.10	
KCAX7	KCAXL7	.4375	.562	.437	2.438	1.312	.812	1.500	1/2-20	12	10.101	.14	
KCAX8	KCAXL8	.5000	.625	.500	2.625	1.500	.937	1.625	5/8-18	10	13.447	.20	
KCAX10	KCAXL10	.6250	.750	.562	2.875	1.750	1.125	1.750	3/4-16	13	17.393	.32	

PART NO.		DIMENSIONS IN MILLIMETERS										Radial Static Load Cap. Kilograms	Approx. Brg. Wt. Grams
Right Hand	Left Hand	B	W	H	A	D	Ball Dia. Ref.	C	Thread UNF-3A	α ° Mounting Angle			
KCAX5	KCAXL5	7.94 + .0381 - .0127	11.10 + .000 - .127	8.74 ± .127	49.23 ± .381	25.40 ± .254	15.88	31.75 + 1.574 - .787	3/8-24	12	2.535	27	
KCAX6	KCAXL6	9.53	12.70	10.31	53.98	28.58	18.26	34.93	7/16-20	10	3.420	45	
KCAX7	KCAXL7	11.11	14.27	11.10	61.93	33.32	20.62	38.10	1/2-20	12	4.582	64	
KCAX8	KCAXL8	12.70	15.88	12.70	66.66	38.10	23.80	41.28	5/8-18	10	6.099	91	
KCAX10	KCAXL10	15.88	19.05	14.27	73.03	44.45	28.58	44.45	3/4-16	13	7.889	145	

MATERIALS

BALL	RACE	BODY
52100 STEEL R/C 56 MIN. HARD CHROME PLATED	STEEL ALLOY HEAT TREATED ZINC PLATED CHROMATE TREATED	7075-T6 HIGH STRENGTH ALUMINUM HARD COAT ANODIZE