

KCAX-T ALUMINUM SERIES

HIJ

3 PIECE, HEAVY DUTY

MALE ROD ENDS ••• SELF LUBRICATING

KCAX-T

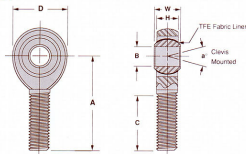

PART NO.		DIMENSIONS IN INCHES								Radial Static Load Cap. Lbs.	Approx. Brg. Wt. Lbs.	
Right Hand	Left Hand	B	W	H	A	D	Ball Dia. Ref.	C	Thread			α Misalign. Angle
KCAX5T	KCAXL5T	.3125 + .0015 - .0005	.437 + .000 - .005	.344 ± .005	1.938 ± 0.15	1.000 ± 0.10	.625	1.250 + .062 - .031	3/8-24	12	5.589	.06
KCAX6T	KCAXL6T	.3750	.500	.406	2.125	1.125	.719	1.375	7/16-20	10	7.539	.10
KCAX7T	KCAXL7T	.4375	.562	.437	2.438	1.312	.812	1.500	1/2-20	12	10.101	.14
KCAX8T	KCAXL8T	.5000	.625	.500	2.625	1.500	.937	1.625	5/8-18	10	13.447	.20
KCAX10T	KCAXL10T	.6250	.750	.562	2.875	1.750	1.125	1.750	3/4-16	13	17.393	.32

PART NO.		DIMENSIONS IN MILLIMETERS								Radial Static Load Cap. Kilograms	Approx. Brg. Wt. Grams	
Right Hand	Left Hand	B	W	H	A	D	Ball Dia. Ref.	C	Thread			α Misalign. Angle
KCAX5T	KCAXL5T	7.94 + .0381 - .0127	11.10 + .000 - .127	8.74 ± .127	49.23 ± .381	25.40 ± .254	15.88	31.75 + 1.574 - .787	3/8-24	12	2.535	27
KCAX6T	KCAXL6T	9.53	12.70	10.31	53.98	28.58	18.26	34.93	7/16-20	10	3.420	45
KCAX7T	KCAXL7T	11.11	14.27	11.10	61.93	33.32	20.62	38.10	1/2-20	12	4.582	64
KCAX8T	KCAXL8T	12.70	15.88	12.70	66.68	38.10	23.80	41.28	5/8-18	10	6.099	91
KCAX10T	KCAXL10T	15.88	19.05	14.27	73.03	44.45	28.58	44.45	3/4-16	13	7.889	145

MATERIALS

BALL	RACE	LINER	BODY
52100 STEEL R/C 56 MN HARD CHROME PLATED	STEEL ALLOY HEAT TREATED ZINC PLATED CHROMATE TREATED	TEFLON™ FABRIC PERMANENTLY BONDED TO RACE I.D.	7075 T6 HIGH STRENGTH ALUMINUM HARD COAT ANODIZE