

MTSM

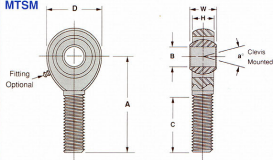

PART NO.		DIMENSIONS IN INCHES										Radial Static Load Cap. Lbs.	Approx. Brg. Wt. Lbs.
Right Hand	Left Hand	B + .0015 - .0035	W + .030 - .055	H ± .005	A ± .015	D ± .010	Ball Dia. Ref.	C + .062 - .031	Thread UNF-3A	α° Misalign. Angle			
MTSM3	MTSML3	1.900	.312	.250	1.250	.625	437	.750	10-32	13	1,169	.028	
MTSM4	MTSML4	2.500	.375	.281	1.562	.750	500	1.000	1/4-28	16	2,158	.043	
MTSM5	MTSML5	3.125	.437	.344	1.875	.875	625	1.250	5/16-24	14	2,784	.072	
MTSM6	MTSML6	3.750	.500	.406	1.938	1.000	719	1.250	3/8-24	12	3,915	.112	
MTSM7	MTSML7	4.375	.562	.437	2.125	1.125	812	1.375	7/16-20	14	4,218	.160	
MTSM8	MTSML8	5.000	.625	.500	2.438	1.312	937	1.500	1/2-20	12	6,660	.249	
MTSM10	MTSML10	6.250	.750	.562	2.625	1.500	1,125	1.625	5/8-18	16	7,364	.382	
MTSM12	MTSML12	7.500	.875	.667	2.875	1.750	1,312	1.750	3/4-16	14	11,518	.602	

PART NO.		DIMENSIONS IN MILLIMETERS										Radial Static Load Cap. Kilograms	Approx. Brg. Wt. Grams
Right Hand	Left Hand	B + .0381 - .0127	W + .000 - .127	H ± .127	A ± .381	D ± .254	Ball Dia. Ref.	C + 1.574 - .762	Thread UNF-3A	α° Misalign. Angle			
MTSM3	MTSML3	4.83	7.92	6.35	31.75	15.88	11.10	19.05	10-32	13	530	13	
MTSM4	MTSML4	6.35	9.53	7.14	39.67	19.05	12.70	25.40	1/4-28	16	979	20	
MTSM5	MTSML5	7.94	11.10	8.74	47.63	22.23	15.88	31.75	5/16-24	14	1,263	33	
MTSM6	MTSML6	9.53	12.70	10.31	49.23	25.40	18.26	31.75	3/8-24	12	1,776	51	
MTSM7	MTSML7	11.11	14.27	11.10	53.98	28.58	20.26	34.93	7/16-20	14	1,913	73	
MTSM8	MTSML8	12.70	15.88	12.70	61.93	33.32	23.80	38.10	1/2-20	12	3,021	113	
MTSM10	MTSML10	15.88	19.05	14.27	66.68	38.10	28.58	41.28	5/8-18	16	3,340	173	
MTSM12	MTSML12	19.05	22.23	17.45	73.03	44.45	33.32	44.45	3/4-16	14	5,225	273	

MATERIALS

BALL	RACE	BODY
S2100 STEEL R/C 58 MIN. HARD CHROME PLATED	STEEL ALLOY HEAT TREATED ZINC PLATED CHROMATE TREATED	LOW CARBON STEEL ZINC PLATED, CHROMATE TREATED