

# RM-T SERIES

3 PIECE, EXTRA STRENGTH, HEAVY DUTY SHANK  
MALE ROD ENDS ••• SELF LUBRICATING

# HIJ

## RM-T

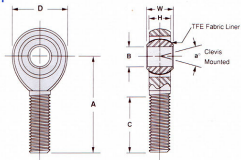

PART NO.		DIMENSIONS IN INCHES										Radial Static Load Cap. Lbs.	Approx. Brg. Wt. Lbs.
Right Hand	Left Hand	B + .0015 - .0005	W + .000 - .005	H ± .005	A ± .015	D ± .010	Ball Dia. Ref.	C + .062 - .031	Thread UNF-3A	α <sup>o</sup> Mounting Angle			
RM3T	RML3T	.1900	.312	.250	1.562	.750	.437	1.000	1/4-28	10	2,158	.043	
RM4T	RML4T	.2500	.375	.281	1.875	.875	.500	1.250	5/16-24	13	3,467	.072	
RM5T	RML5T	.3125	.437	.344	1.938	1.000	.625	1.250	3/8-24	12	5,323	.112	
RM6T	RML6T	.3750	.500	.406	2.125	1.125	.719	1.375	7/16-20	10	7,180	.160	
RM7T	RML7T	.4375	.562	.437	2.438	1.312	.812	1.500	1/2-20	12	9,620	.249	
RM8T	RML8T	.5000	.625	.500	2.625	1.500	.937	1.625	5/8-18	10	12,807	.382	
RM10T	RML10T	.6250	.750	.562	2.875	1.750	1.125	1.750	3/4-16	13	16,565	.602	

PART NO.		DIMENSIONS IN MILLIMETERS										Radial Static Load Cap. Kilograms	Approx. Brg. Wt. Grams
Right Hand	Left Hand	B + .0381 - .0127	W + .000 - .127	H ± .127	A ± .381	D ± .254	Ball Dia. Ref.	C + 1.574 - .787	Thread UNF-3A	α <sup>o</sup> Mounting Angle			
RM3T	RML3T	4.83	7.92	6.35	39.67	19.05	11.10	25.40	1/4-28	10	979	20	
RM4T	RML4T	6.35	9.53	7.14	47.63	22.23	12.70	31.75	5/16-24	13	1,573	33	
RM5T	RML5T	7.94	11.10	8.74	49.23	25.40	15.88	31.75	3/8-24	12	2,415	51	
RM6T	RML6T	9.53	12.70	10.31	53.98	28.58	18.26	34.93	7/16-20	10	3,257	73	
RM7T	RML7T	11.11	14.27	11.10	61.93	33.32	20.62	38.10	1/2-20	12	4,364	113	
RM8T	RML8T	12.70	15.88	12.70	66.68	38.10	23.80	41.28	5/8-18	10	5,809	173	
RM10T	RML10T	15.88	19.05	14.27	73.03	44.45	28.58	44.45	3/4-16	13	7,514	273	

## MATERIALS

BALL	RACE	LINER	BODY
S2100 STEEL R/C 56 MPN HARD CHROME PLATED	STEEL ALLOY HEAT TREATED ZINC PLATED. CHROMATE TREATED	TEFLON <sup>®</sup> FABRIC PERMANENTLY BONDED TO RACE I.D.	STEEL ALLOY HEAT TREATED ZINC PLATED. CHROMATE TREATED