

# SSAF-T SERIES

3 PIECE, TEFLON® LINED  
FEMALE ROD END ••• SELF LUBRICATING

# HIJ

## SSAF-T

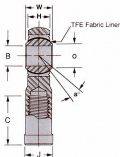
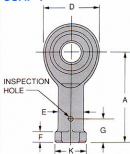

PART NO.		DIMENSIONS IN INCHES													Radial Static Load Cap. Lbs.	Approx. Brg. Wt. Lbs.		
Right Hand	Left Hand	B +0.000 -0.005	W +0.00 -0.02	H ±.005	A ±.010	D ±.010	O REF.	E ±.010	K REF.	J +0.02 -0.10	F +0.01 -0.02	Ball Dia. Ref.	C MIN.	G DIM.			Thread UNF 3B	a° Misalign Angle
SSAF3T	SSAFL3T	.1900	.437	.337	1.375	.805	.30	.422	.500	.437	.188	.531	.750	.375	5/16-24	15	2,360	.080
SSAF4T	SSAFL4T	.2500	.437	.337	1.469	.805	.30	.422	.500	.437	.188	.531	.750	.375	5/16-24	15	4,860	.084
SSAF5T	SSAFL5T	.3125	.437	.327	1.625	.900	.36	.485	.580	.500	.250	.593	.875	.437	3/8-24	14	7,180	.102
SSAF6T	SSAFL6T	.3750	.500	.416	1.812	1.025	.47	.547	.660	.562	.250	.687	1.000	.437	3/8-24	8	8,550	.161
SSAF7T	SSAFL7T	.4375	.562	.452	2.000	1.150	.54	.610	.720	.625	.250	.781	1.125	.500	7/16-20	10	12,000	.212
SSAF8T	SSAFL8T	.5000	.625	.515	2.250	1.337	.61	.735	.880	.750	.250	.875	1.250	.562	1/2-20	9	19,500	.325
SSAF10T	SSAFL10T	.6250	.750	.577	2.500	1.525	.75	.860	1.020	.875	.375	1.062	1.375	.687	5/8-18	12	21,900	.481
SSAF12T	SSAFL12T	.7500	.875	.640	2.875	1.775	.85	.985	1.160	1.000	.375	1.250	1.625	.812	3/4-16	13	29,300	.673

PART NO.		DIMENSIONS IN MILLIMETERS													Radial Static Load Cap. Kilograms	Approx. Brg. Wt. Grams		
Right Hand	Left Hand	B +0.000 -0.127	W +0.00 -0.51	H ±.127	A ±.254	D ±.254	O REF.	E ±.254	K REF.	J +0.01 -0.254	F +0.254 -1.575	Ball Dia. Ref.	C MIN.	G DIM.			Thread UNF 3B	a° Misalign Angle
SSAF3T	SSAFL3T	4.83	11.10	8.56	34.93	20.47	7.62	10.72	12.70	11.10	4.78	13.49	19.05	9.53	5/16-24	15	1,070	36
SSAF4T	SSAFL4T	6.35	11.10	8.56	37.31	20.47	7.62	10.72	12.70	11.10	4.78	13.49	19.05	9.53	5/16-24	15	2,204	38
SSAF5T	SSAFL5T	7.94	11.10	8.31	41.28	22.86	9.14	12.32	14.73	12.70	6.35	15.06	22.23	11.10	3/8-24	14	3,257	46
SSAF6T	SSAFL6T	9.53	12.70	10.57	46.02	26.04	11.94	13.89	16.76	14.27	6.35	17.45	25.40	11.10	3/8-24	8	3,878	73
SSAF7T	SSAFL7T	11.11	14.27	11.48	50.80	29.21	13.72	15.49	18.29	15.88	6.35	19.84	28.58	12.70	7/16-20	10	5,443	96
SSAF8T	SSAFL8T	12.70	15.88	13.08	57.15	33.96	15.49	18.67	22.35	19.05	6.35	22.23	31.75	14.27	1/2-20	9	8,845	147
SSAF10T	SSAFL10T	15.88	19.05	14.66	63.50	38.74	19.05	21.84	25.91	22.23	9.53	26.97	34.93	17.45	5/8-18	12	9,934	218
SSAF12T	SSAFL12T	19.05	22.23	16.26	73.03	45.09	21.59	25.02	29.46	25.40	9.53	31.75	41.28	20.62	3/4-16	13	13,290	305

## MATERIALS

BALL	RACE	LINER	BODY
440 C CRS R/C 55-62	410 CRS R/C 23-35	TEFLON® FABRIC PERMANENTLY BONDED TO RACE I.D.	17-4 PH CRS HEAT TREATED MAGNIFLUXED