

3 PIECE, HEAVY DUTY, METAL-TO-METAL MALE ROD ENDS

TSMX

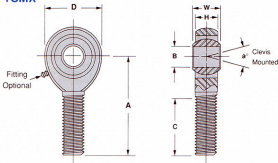

PART NO.		DIMENSIONS IN INCHES								Radial Static Load Cap. Lbs.	Approx. Brg. Wt. Lbs.	
Right Hand	Left Hand	B	W	H	A	D	Ball Dia. Ref.	C	Thread UNF-3A			α° Misalign. Angle
TSMX3	TSMXL3	.1900 + .0015 - .0005	.312 + .020 - .025	.250 ± .005	1.250 ± .010	.625 ± .010	.437	.750	10-32	13	2,851	.028
TSMX4	TSMXL4	.2500	.375	.281	1.562	.750	.500	1.000	1/4-28	16	5,260	.043
TSMX5	TSMXL5	.3125	.437	.344	1.875	.875	.625	1.250	5/16-24	14	7,639	.072
TSMX6	TSMXL6	.3750	.500	.406	1.938	1.000	.719	1.250	3/8-24	12	9,544	.112
TSMX7	TSMXL7	.4375	.562	.437	2.125	1.125	.812	1.375	7/16-20	14	10,285	.160
TSMX8	TSMXL8	.5000	.625	.500	2.438	1.312	.937	1.500	1/2-20	12	16,238	.249
TSMX10	TSMXL10	.6250	.750	.562	2.625	1.500	1.125	1.625	5/8-18	16	17,955	.382
TSMX12	TSMXL12	.7500	.875	.687	2.875	1.750	1.312	1.750	3/4-16	14	28,081	.602

PART NO.		DIMENSIONS IN MILLIMETERS								Radial Static Load Cap. Kilograms	Approx. Brg. Wt. Grams	
Right Hand	Left Hand	B	W	H	A	D	Ball Dia. Ref.	C	Thread UNF-3A			α° Misalign. Angle
TSMX3	TSMXL3	4.83 + .0381 - .0127	7.92 + .000 - .127	6.35 ± .127	31.75 ± .254	15.88 ± .254	11.10	19.05	10-32	13	1,293	13
TSMX4	TSMXL4	6.35	9.53	7.14	39.67	19.05	12.70	25.40	1/4-28	16	2,386	20
TSMX5	TSMXL5	7.94	11.10	8.74	47.63	22.23	15.88	31.75	5/16-24	14	3,465	33
TSMX6	TSMXL6	9.53	12.70	10.31	49.23	25.40	18.26	31.75	3/8-24	12	4,329	51
TSMX7	TSMXL7	11.11	14.27	11.10	53.98	28.58	20.62	34.93	7/16-20	14	4,665	73
TSMX8	TSMXL8	12.70	15.88	12.70	61.93	33.32	23.80	38.10	1/2-20	12	7,366	113
TSMX10	TSMXL10	15.88	19.05	14.27	66.68	38.10	28.58	41.28	5/8-18	16	8,144	173
TSMX12	TSMXL12	19.05	22.23	17.45	73.03	44.45	33.32	44.45	3/4-16	14	12,738	273

MATERIALS

BALL	RACE	BODY
52100 STEEL R/C 58 MIN. HARD CHROME PLATED	STEEL ALLOY HEAT TREATED ZINC PLATED, CHROMATE TREATED	STEEL ALLOY HEAT TREATED ZINC PLATED, CHROMATE TREATED